

# PARTS LIST AND OPERATING INSTRUCTIONS FOR NUMBER 25 AND NUMBER 40 DOUBLE AUTOMATIC CENTERING REEL WITH ELECTRIC BRAKES

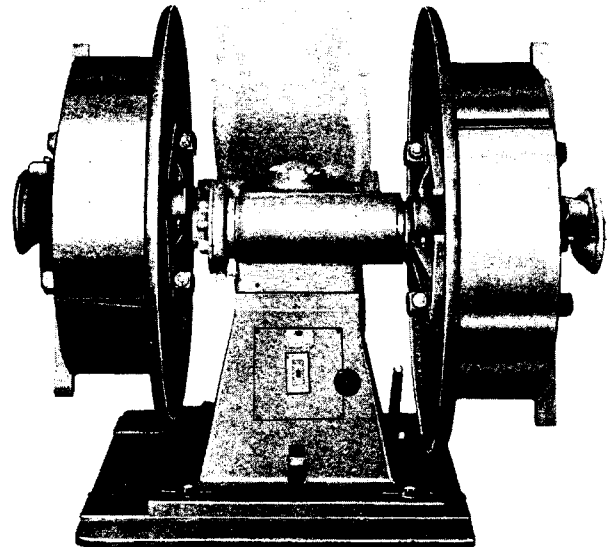
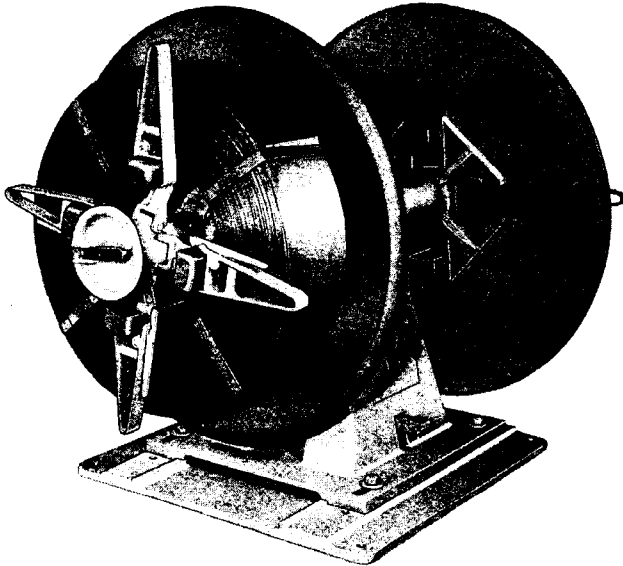

## CAPACITIES

SIZE OF REEL		25-12	25-18	25-24	40-18	40-24
MAX WEIGHT OF COIL ON EACH SIDE		2500 lbs	2500 lbs	2500 lbs	4000 lbs	4000 lbs
INSIDE DIA.	3-ARM REEL	12"-14"	12"-14"	12"-14"	12"-14"	12"-14"
	4-ARM REEL	16"-20" or 18"-22"	16"-20" or 18"-22"	16"-20" or 18"-22"	16"-20" or 18"-22"	16"-20" or 18"-22"
MAX OUTSIDE DIA.		40"	40"	40"	45"	45"
MAX WIDTH		12"	18"	24"	18"	24"

## F. J. LITTELL MACHINE CO.

4101 N. RAVENSWOOD AVENUE

CHICAGO, ILLINOIS 60613

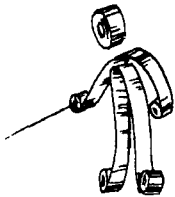

SEE NOTE IN  
PARTS LIST  
MARKED †

**IMPORTANT**

When ordering repair parts, specify part number plus serial number, code number and size of machine. Send all repair parts orders to the Chicago factory.

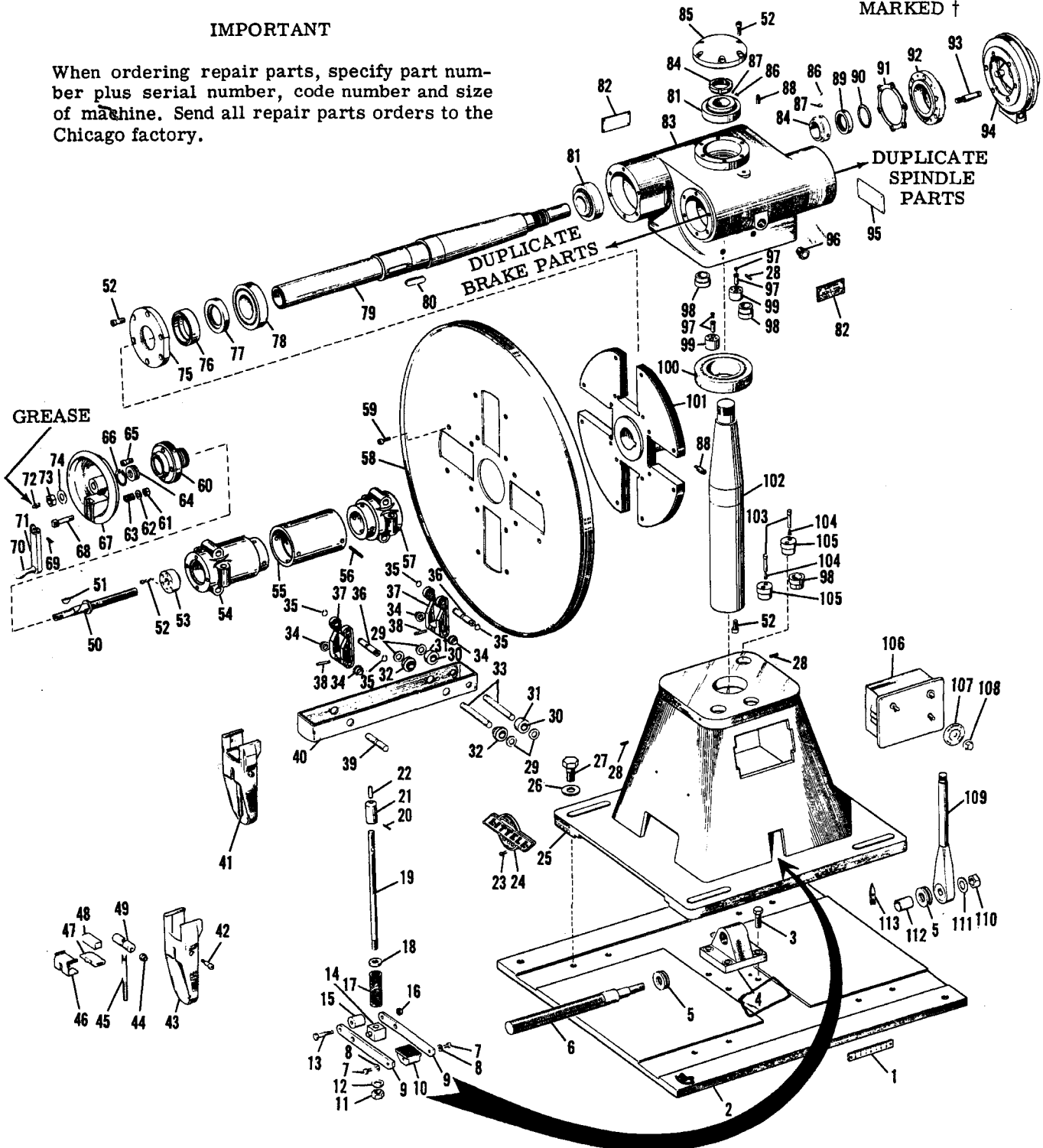

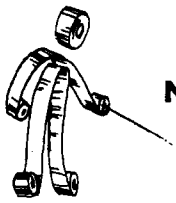

# No. 25 AND No. 40 DOUBLE AUTOMATIC CENTERING REEL WITH ELECTRIC BRAKES



## PARTS LIST

INDEX NO.	DESCRIPTION	PART NUMBER	
		#25-18 REEL	#40-18 REEL
1	Scale . . . . .	45A 11823	45A 11823
2	Plate, Base . . . . .	45B 35656	45B 35656
3	Screw, Cap, Hex Head . . . . .	3/4" x 2" x 1/4"	3/4" x 2" x 1/4"
4	Bracket, Adjusting Screw . . . . .	45A 35702	45A 35702
5	Bearing, Thrust (Aetna #E-13)	42 90113	42 90113
6	Screw, Base Adjusting . . . . .	45A 35658	45A 35658
7	Screw, Machine, Hex Head . . . . .	3/8" - 16 x 3/4" Lg.	3/8" - 16 x 3/4" Lg.
8	Washer, Lock . . . . .	3/8" I. D.	3/8" I. D.
9	Lever, Foot . . . . .	45A 35660	45A 19996
10	Block, Foot Lever . . . . .	45A 35662	45A 35662
11	Nut, Stop, Elastic, 3/4" - 10	15 90209	15 90209
12	Washer . . . . .	3/4" I. D.	3/4" I. D.
13	Bolt . . . . .	1/2" x 2-3/4" Lg.	1/2" x 2-3/4" Lg.
14	Trunnion, Foot Lever . . . . .	45A 35661	45A 35661
15	Roller, Foot Lever . . . . .	45A 35663	45A 35663
16	Nut, Stop, Elastic, 1/2" I. D.	32 90021	32 90021
17	Spring, Medium Pressure (Danly #9-2418-11)	45 91034	45 91034
18	Collar (Hallowell) . . . . .	41 90162	41 90162
19	Rod, Lock . . . . .	45A 28477	45A 28477
20	Pin (Esna #59-048-250-1250)	45 91940	45 91940
21	Lock, Rod End . . . . .	45A 28478	45A 28478
22	Plug, Nylon . . . . .	99 91178	99 91178
23	Screw, Flat Head, Self-Tapping . . . . .	1/4" x 3/4"	1/4" x 3/4"
24	Plate, Name . . . . .	24B 34003	24B 34003
25	Base . . . . .	45B 35655	45 26714
26	Washer, Steel . . . . .	13 34587	13 34587
27	Screw, Cap, Hex Head . . . . .	1" - 8 x 3" Lg.	1" - 8 x 3" Lg.
28	Screw, Set, Socket Head . . . . .	1/4" - 20 x 1" Lg.	1/4" - 20 x 1" Lg.
29	Washer . . . . .	14 23214	14 23214
30	Bushing (Oilite #AA-1049-1)	99 90346	99 90346
31	Roller, Arm . . . . .	45A 35601	45A 35601
32	Roller . . . . .	45A 24628	45A 24628
33	Pin, Roller . . . . .	45 35602	45 35602
34	Bushing, Arm . . . . .	45A 25568	45A 25568
35	Ring, Retaining (Waldes #5100-75)	33 90011	33 90011
36	Pin, Lower Link . . . . .	45A 23969	45A 23969
*37	Link . . . . .	45 25583	45 25583
38	Pin, Roll (Esna #59-048-250-1500)	45 91546	45 91546
39	Pin, Link . . . . .	45A 23959	45A 23959
**40	Arm, Reel . . . . .	45 35590	45 35590
41	Assembly, Keeper . . . . .	45C 17780	45C 17780
	Consisting of:		
42	Bolt, Stripper . . . . .	42 90844	42 90844
43	Body, Keeper Assembly . . . . .	45C 17782	45C 17782
44	Bushing, Pivot . . . . .	46A 35857	46A 35857
45	Handle, Cam . . . . .	46A 35856	46A 35856
46	Shoe, Front Clamp . . . . .	45B 20191	45B 20191
47	Plate, Pressure . . . . .	45B 25486	45B 25486
48	Pad, Pressure . . . . .	45A 20132	45A 20132
49	Cam, Eccentric . . . . .	45A 17790	45A 17790
50	Screw, Adjusting . . . . .	45 25466	45 25466
51	Key, Woodruff . . . . .	#15	#15
52	Screw, Cap, Hollow Head . . . . .	3/8" - 16	3/8" - 16
53	Nut, Adjusting Screw . . . . .	45A 25465	45A 25465
54	Sleeve, Spindle, Front . . . . .	45C 25566	45C 25566
55	Tube, Spacer . . . . .	45 25595	45 25595
56	Pin, Roll (Esna #59-062-312-750)	45 91547	45 91547
57	Sleeve, Spindle, Rear . . . . .	45C 25567	45C 25567
58	Plate, Disc . . . . .	45 45876	45 45876
59	Screw, Cap, Socket Head . . . . .	3/8" - 16 x 1-3/4" Lg.	3/8" - 16 x 1-3/4" Lg.
60	Retainer, Bearing Adjusting Screw . . . . .	45B 25581	45B 25581

INDEX NO.	DESCRIPTION	PART NUMBER	
		#25-18 REEL	#40-18 REEL
61	Nut, Stop, Elastic 1/2" - 20	45 90959	45 90959
62	Washer . . . . .	7/32" I. D.	17/32" I. D.
63	Spring (Danly Die #9-1808-11)	46 90007	46 90007
64	Bearing, Ball (Fafnir #206W)	99 91552	99 91552
65	Screw, Cap, Hollow Head . . . . .	1/2" x 1"	1/2" x 1"
66	Ring, Retaining (Waldes #5000-244)	45 91418	45 91418
67	Wheel, Hand . . . . .	45C 25580	45C 25580
68	Pin, Handle Spring . . . . .	46A 35881	46A 35881
69	Pin, Roll (Esna #59-062-312-1250)	45 91982	45 91982
70	Handle, Revolving (Cinn. #H-29426)	42 90424	42 90424
71	Bar, Handle . . . . .	45B 25591	45B 25591
72	Fitting, Grease (Alemite) I. P. S.	#1610, 1/8" I. P. S.	#1610, 1/8" I. P. S.
73	Nut, Hex, Jam . . . . .	1" - 14 R. H.	1" - 14 R. H.
74	Washer, Bearing Thrust . . . . .	45A 27502	45A 27502
75	Retainer, Front Bearing . . . . .	45A 25473	45A 25473
76	Sleeve, Oil Seal . . . . .	45 25472	45 25472
77	Seal, Oil (C. R. #42411)	99 91708	99 91708
78	Bearing, Roller (Timken #594-592A)	45 90149	45 90149
79	Shaft, Spindle . . . . .	45 25468	45 25468
80	Key . . . . .	45A 27503	45A 27503
81	Bearing, Roller (Timken #623-612)	45 90151	45 90151
82	Plate, Caution . . . . .	45A 28458	45A 28458
83	Case, Bearing . . . . .	45C 35701	45C 35701
84	Nut, Lock, Bearing . . . . .	45A 35762	45A 35762
85	Cap, Rear Bearing Case . . . . .	45A 35785	45A 35785
86	Screw, Socket Head . . . . .	1/4" - 20 x 3/8" Lg.	1/4" - 20 x 3/8" Lg.
87	Button, Brass . . . . .	41A 35018	41A 35018
88	Screw, Set, Dog Point . . . . .	5/8" - 11 x 1-1/8" Lg.	3/4" - 10 x 1-1/4" Lg.
89	Seal, Oil . . . . .	45 90704	45 90704
90	O-Ring (Parker #2-154 Comp. #N-183-9)	99 91709	99 91709
91	Shim Set (Timken #19)	45 90460	45 90460
92	Retainer, Rear Bearing . . . . .	45B 35786	45B 35786
93	Pin, Drive . . . . .	45A 24871	45A 24871
94	Brake Unit, Electric . . . . .	45 91716	45 91716
95	Plate, Name . . . . .	45A 35728	45A 35728
96	Plug, Oil Gauge (Gits #4054 Style BW 1")	45 90848	45 90848
97	Assembly, Brush . . . . .	45 91006	45 91006
98	Bushing, Hardened Steel . . . . .	45A 28030	45A 28030
99	Holder, Brush . . . . .	45A 35666	45A 35666
100	Bearing, Roller (Timken #71450-71750)	43 90155	43 90155
101	Hub, Disc . . . . .	45C 25575	45C 25575
102	Post, Bearing Case . . . . .	45B 35657	45B 35657
103	Contact, Brake . . . . .	45A 35664	45A 35664
104	Screw . . . . .	#8 - 32 x 5/16" Lg.	#8 - 32 x 5/16" Lg.
105	Holder, Brake Contact . . . . .	45A 35665	45A 35665
106	Power Pack, D. C. . . . .	95 90586	95 90586
107	Dial Plate, Rheostat . . . . .	45A 35747	45A 35747
108	Knob, Rheostat . . . . .	#5150	#5150
109	Wrench, Ratchet, Reversible (Lowell #24)	42 90472	42 90472
110	Nut . . . . .	1"	1"
111	Washer . . . . .	13 34587	13 34587
112	Bushing (Oilite #A-1517-6)	42 90357	42 90357
113	Pointer, Indicator . . . . .	24A 12312	24A 12312
†	Hub (Not Illustrated) . . . . .		45A 37566
†	Adaptor (Not Illustrated) . . . . .		45A 37567

\* Specify I. D. required.

\*\* Specify whether for 12", 18" or 24" wide reel.

† NOTE: These parts used for 12-inch brake on #40-18 reel only.



# No. 25 AND No. 40 DOUBLE AUTOMATIC CENTERING REEL WITH ELECTRIC BRAKES

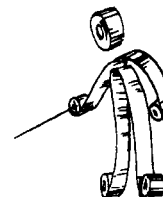

## OPERATING INSTRUCTIONS

A. **ELECTRICAL CONNECTION.** Connect the reel to the correct electrical voltage.

### CAUTION

Be sure power source is correct for reel by checking voltage requirement on brake reel nameplate.

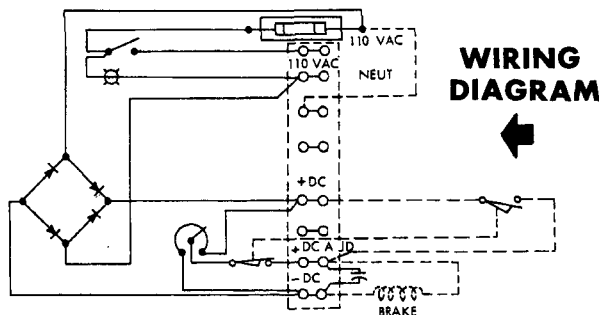

B. **REMOVE KEEPERS.** Release keeper catch and slide keepers (41) from arms.

C. **COLLAPSE ARMS.**

- (1) Turn crank handle (70) in a counterclockwise direction to collapse arms so that they are at least 1 or 2 inches smaller than the inside diameter of the coil to be loaded.
- (2) Fold handle (70) in to prevent breakage.

D. **LOAD COIL.**

- (1) Load coil using a coil loading hook. Suspend hook from a hoist and insert in coil.
- (2) Raise coil to the proper height.
- (3) Slide coil onto the arm of the reel on the side which is not paying off stock.

E. **EXPAND ARMS.**

- (1) Unfold crank.
- (2) Turn hand crank in a clockwise direction until the arms are fully extended against the coil.
- (3) Remove hook.
- (4) Fold handle in to prevent breakage.

F. **ATTACH KEEPERS.** Slide keepers (41) into position on the arms (40) so that the coil is tight against the guide plate (58).

G. **ADJUST BRAKE TENSION.** Adjust the rheostat to obtain the desired amount of drag.

H. **ALIGNING REEL WITH USING EQUIPMENT.**

- (1) Loosen four cap screws (27).
- (2) By turning screw (6) with ratchet wrench (109), the base (25) can be moved one way or the other so that the coil can be lined up with the using equipment.

I. **PLACE COIL IN PAY-OFF POSITION.**

- (1) When the coil in the pay-off position has been used up, the new coil can be brought into position by depressing the foot lever block (10) and rotating the complete double spider assembly.
- (2) Rotate the double spider assembly slowly and release the foot lever block (10). As the new coil swings into pay-off position, the lock rod will snap up into the bearing case and lock the spider in the correct position.

J. **EMERGENCY STOPS.** Wire the electric brake into the stop button of the production line. In doing so, full brake will be automatically applied when the balance of line is shut down.

## MAINTENANCE INSTRUCTIONS

All Littell Reels are of very rigid construction and, if the capacities are not exceeded, will give years of trouble-free service. Proper lubrication is the only maintenance required. Apply grease to grease fittings on spindle and on end of hand wheel.

**GEAR CASE OIL.** Medium heavy oil SAE 40 should be used in gear case. Remove bearing case cap (85) and fill case to bring oil level up to the middle of sight gage.

**F. J. LITTELL MACHINE CO.**

4101 N. RAVENSWOOD AVENUE

CHICAGO, ILLINOIS 60613