

PARTS LIST AND OPERATING INSTRUCTIONS FOR NUMBER 10 DOUBLE AUTOMATIC CENTERING REEL

LITTELL

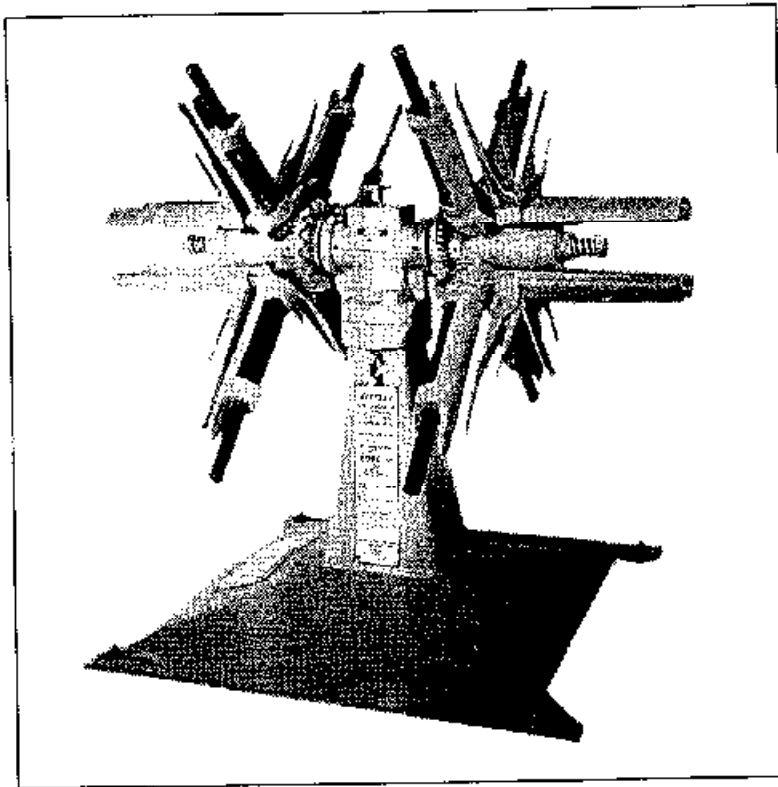

MAX. WEIGHT OF COIL	1000 lbs. each side
INSIDE DIAMETER	12" - 21"
MAX. OUTSIDE DIAMETER	48"
MAX. WIDTH	13"

OPERATING AND MAINTENANCE INSTRUCTIONS

OPERATING INSTRUCTIONS

A. REMOVE KEEPERS. Release keeper catch (36) and remove keepers (32) from arms.

B. COLLAPSE ARMS.

(1) Position spider so that one of the arms (27) is in a vertical (12:00 o'clock) position.

(2) Push locking pin (46) inward to prevent spider from rotating.

(3) Turn ratchet handle (12A), on the side of the reel being loaded, to "Contract" position.

(4) Move ratchet handle in an up and down motion until the arms (27) are contracted to at least 1 to 2 inches smaller than the inside diameter of the coil to be loaded.

C. ATTACH KEEPERS. Snap keepers (32) into position on the arms so that the coil is tight against the back portion of the arms.

D. EXPAND ARMS.

(1) Turn ratchet handle (12A) to "Expand" position.

(2) Move ratchet handle in an up and down motion until the coil is held firmly by all four of the arms.

(3) Turn ratchet handle to the "Neutral" position.

(4) Pull outward on locking pin (46) to release spider.

E. PLACE COIL IN PAY-OFF POSITION.

(1) Pull upward on swivel pin handle (11) to disengage swivel pin (6) from hole in top of base.

(2) Pivot the spider heads on the base until the full coil is moved into the pay-off position. The swivel pin will automatically lock at a position of 180°.

F. ADJUST SPIDER TENSION. The friction cap (43) can be adjusted to maintain desired tension on the spider by loosening or tightening friction nut (45).

MAINTENANCE INSTRUCTIONS

All Littell Reels are of very rigid construction and, if the capacities are not exceeded, will give years of trouble-free service. The only maintenance required is the oiling at the points shown on the exploded view drawing.

LITTELL INTERNATIONAL, INC.
145 SWIFT ROAD, ADDISON, ILLINOIS 60101-1407, U.S.A.
AREA CODE: (630) 916-6662 LITTELL TELEFAX: (630) 916-6663
SERVICE DEPARTMENT TELEFAX: (630) 916-6664

LITTELL No. 10 DOUBLE AUTOMATIC CENTERING REEL

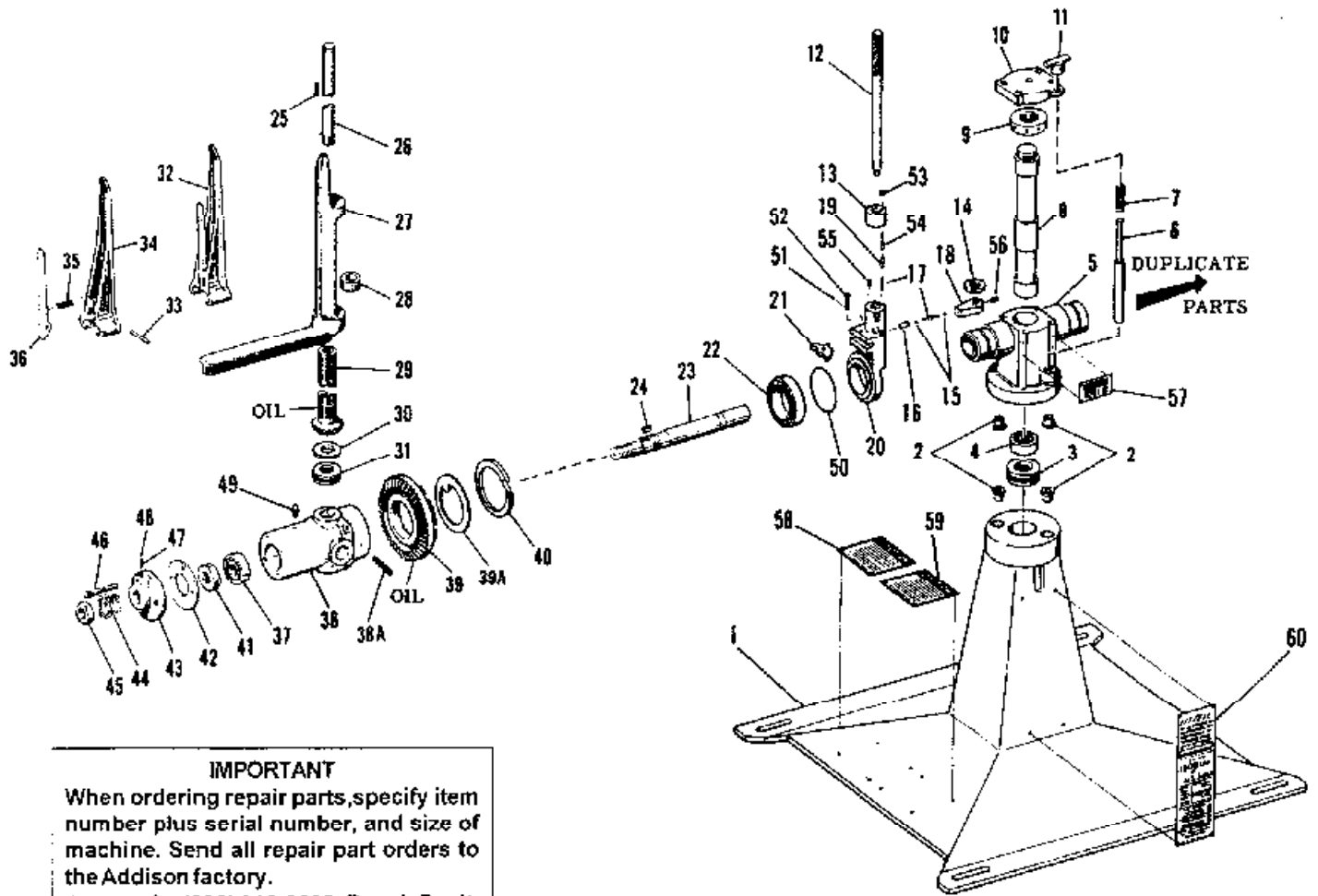

IMPORTANT

When ordering repair parts, specify item number plus serial number, and size of machine. Send all repair part orders to the Addison factory.
Area code: (630) 916-6662, Repair Dep't.

PARTS LIST

INDEX NO.	DESCRIPTION	INDEX NO.	DESCRIPTION	INDEX NO.	DESCRIPTION	INDEX NO.	DESCRIPTION
1	Base	16	Plunger, Detent	33	Pin, Roll (Esna No. 59-048-250-1500)	47	Spring, Detent
2	Bushing, Shoulder, 0.875" I.D. x 1-1/4" Long (Acme Type "S" Group No. 12)	17	Spring, Ratchet	34	Keeper	48	Ball, Detent
3	Bearing, Thrust (Aetna No. E-30)	18	Latch, Ratchet Spring	35	Spring (Danly No. 9-1206-11)	49	Fitting, Straight Hyd. Drive Type "Alemite" No. 1743-B
4	Bearing, Needle (RBC No. SJ-8406)	19	Pin, Lock	36	Catch, Keeper	50	Ring, Retaining "Waldes" Tru-Arc No. S100-350
5	Head, Swivel	20	Head, Ratchet	37	Bearing, Roller (Timken No. 2788-2729)	51	Pin, Cotter
6	Pin, Swivel	21	Pawl, Ratchet	38	Hub, Spindle	52	Pin, Clevis "Durman" No. 120-003 .31" x 1.25"
7	Spring, 3" Long (Gardner No. 8C13-C.O.)	22	Bearing, Roller (Timken No. 438-432)	38A	Pin, Roll	53	Thumb Collar
8	Post, Pivot	23	Shaft, Spindle	39	Gear, Bevel	54	Plunger
9	Collar, Pivot Post	24	Key, Woodruff	39A	Washer, Thrust	55	Pin, Dowel
10	Cap, Swivel Head	25	Key, Straight Arm	40	Ring, Retaining (Spiralox No. KS1-500)	56	Screw, Set
11	Handle, Swivel Pin	26	Arm, Straight	41	Nut, Bearing, Jam	57	Plate, Name, Warning Instruction
12	Handle, Ratchet	27	Arm, Reel	42	Washer, Friction	58	Plate, Name, Instruction
13	Collar, Ratchet	28	Collar, 3-3/8" I.D. (Hallowell)	43	Cap, Friction	59	Plate, Name, Safety
14	Spacer	29	Screw and Pinion	44	Spring, Friction	60	Plate, Name, Capacity
15	Ball, Steel	30	Washer, Thrust (Oilite No. T-1900)	45	Nut, Friction, Jam		
		31	Bearing, Thrust (Aetna No. E-15)	46	Pin, Locking		
		32	Assembly, Keeper Consisting of:				