

SECTION III

AIR RELEASED STRAP TYPE BRAKE

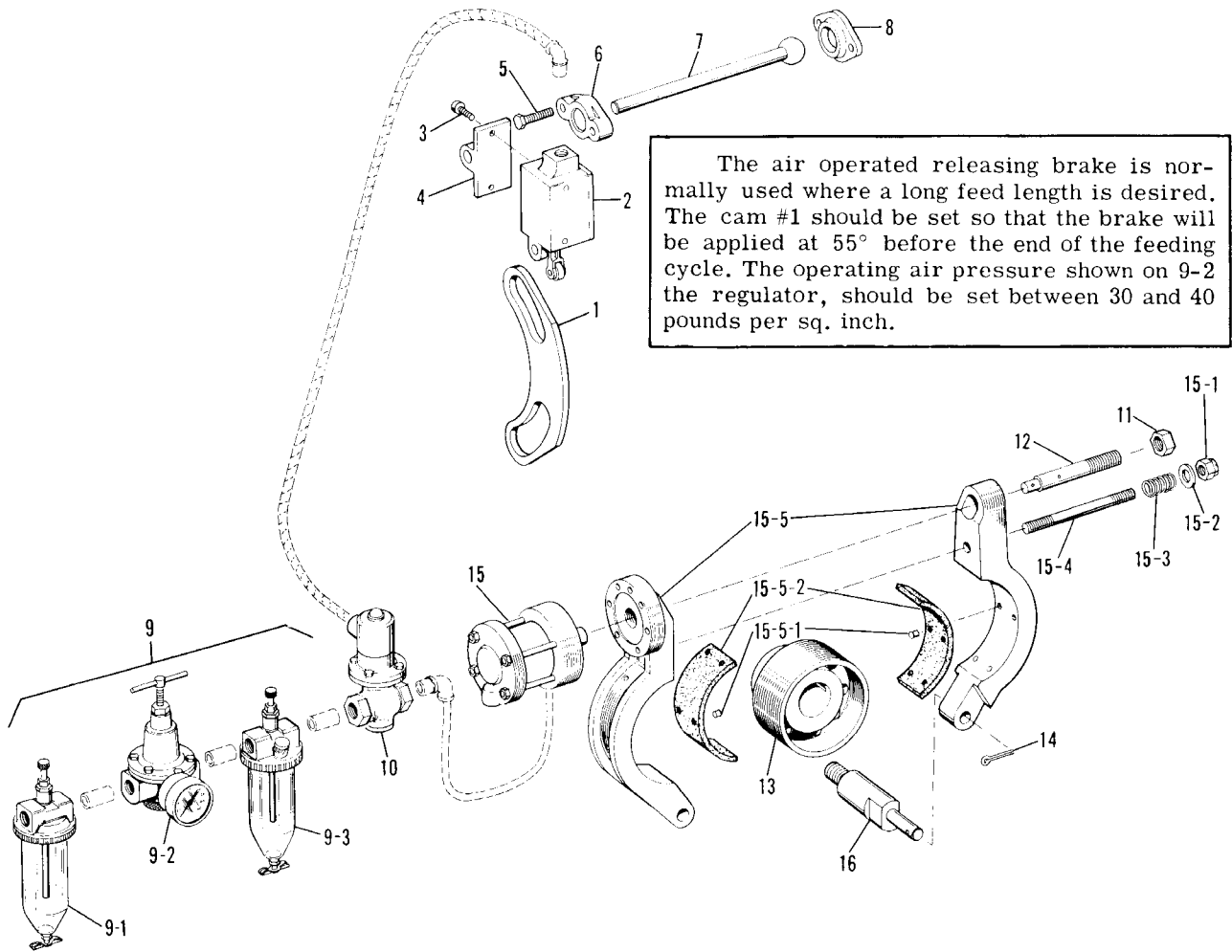

The air operated releasing brake is normally used where a long feed length is desired. The cam #1 should be set so that the brake will be applied at 55° before the end of the feeding cycle. The operating air pressure shown on 9-2 the regulator, should be set between 30 and 40 pounds per sq. inch.

| INDEX NO | DESCRIPTION |
|----------|--|
| 1 | Cam |
| 2 | Switch - Limit Snap-lock |
| 3 | Screw - Socket-head Cap |
| 4 | Bracket - Switch |
| 5 | Screw - Hex-head Cap |
| 6 | Plate - Ball Clamp |
| 7 | Post - Large Ball-head |
| 8 | Plate - Ball Base |
| 9 | Assembly - Control Unit Lubro Consisting of: 9-1 Filter - Manual Drain 9-2 Pressure Regulator 9-3 Lubricator |
| 10 | Valve - Air |
| 11 | Nut - Elastic Stop |

| INDEX NO. | DESCRIPTION |
|-----------|--|
| 12 | Pin - Extension Air Cylinder |
| 13 | Brake Collar |
| 14 | Pin - Cotter |
| 15 | Assembly - Air Operated Brake Consisting of: 15-1 Nut - Elastic Stop 15-2 Washer - Steel 15-3 Spring - Brake 15-4 Stud - Brake 15-5 Assembly - Brake Straps Consisting of: 15-5-1 Rivet - Brake 15-5-2 Lining - Brake |
| 16 | Anchor - Brake |