

PARTS LIST AND OPERATING INSTRUCTIONS
FOR
NUMBER 3G AND NUMBER 5G AUTOMATIC CENTERING
REELS WITH AUTOMATIC BRAKE

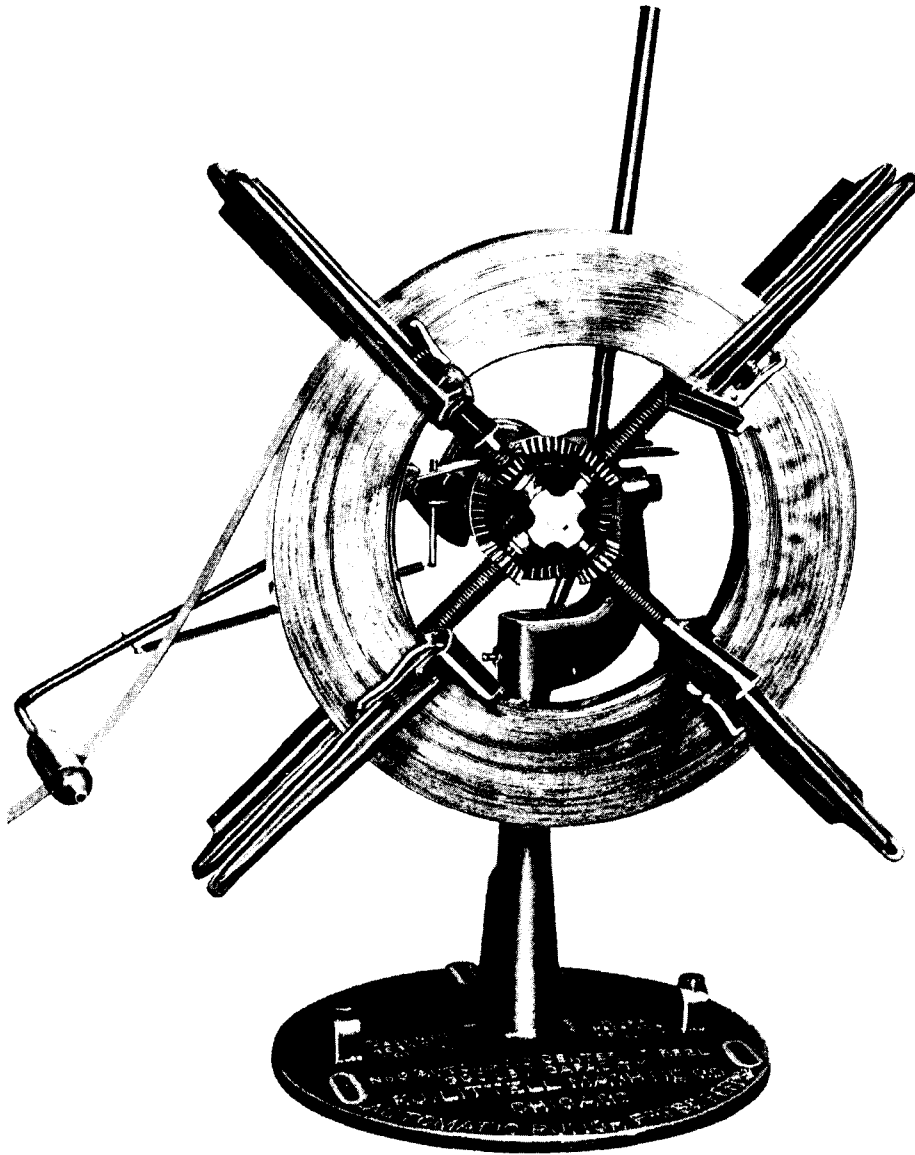

CAPACITIES

	MAX. WEIGHT OF COIL	INSIDE DIA.	MAX. OUTSIDE DIA.	MAX. WIDTH
NO. 3G REEL	300 lbs.	10" to 20"*	46"	6-1/2"
NO. 5G REEL	600 lbs.	10" to 20"	46"	10"

* Also available for 4" to 16" inside diameter of coils.

F. J. LITTELL MACHINE CO.

4101 NORTH RAVENSWOOD AVENUE

CHICAGO 13, ILLINOIS

Form No. 705-1

62

Page 1

No. 3G AND No. 5G AUTOMATIC CENTERING REELS WITH
AUTOMATIC BRAKE

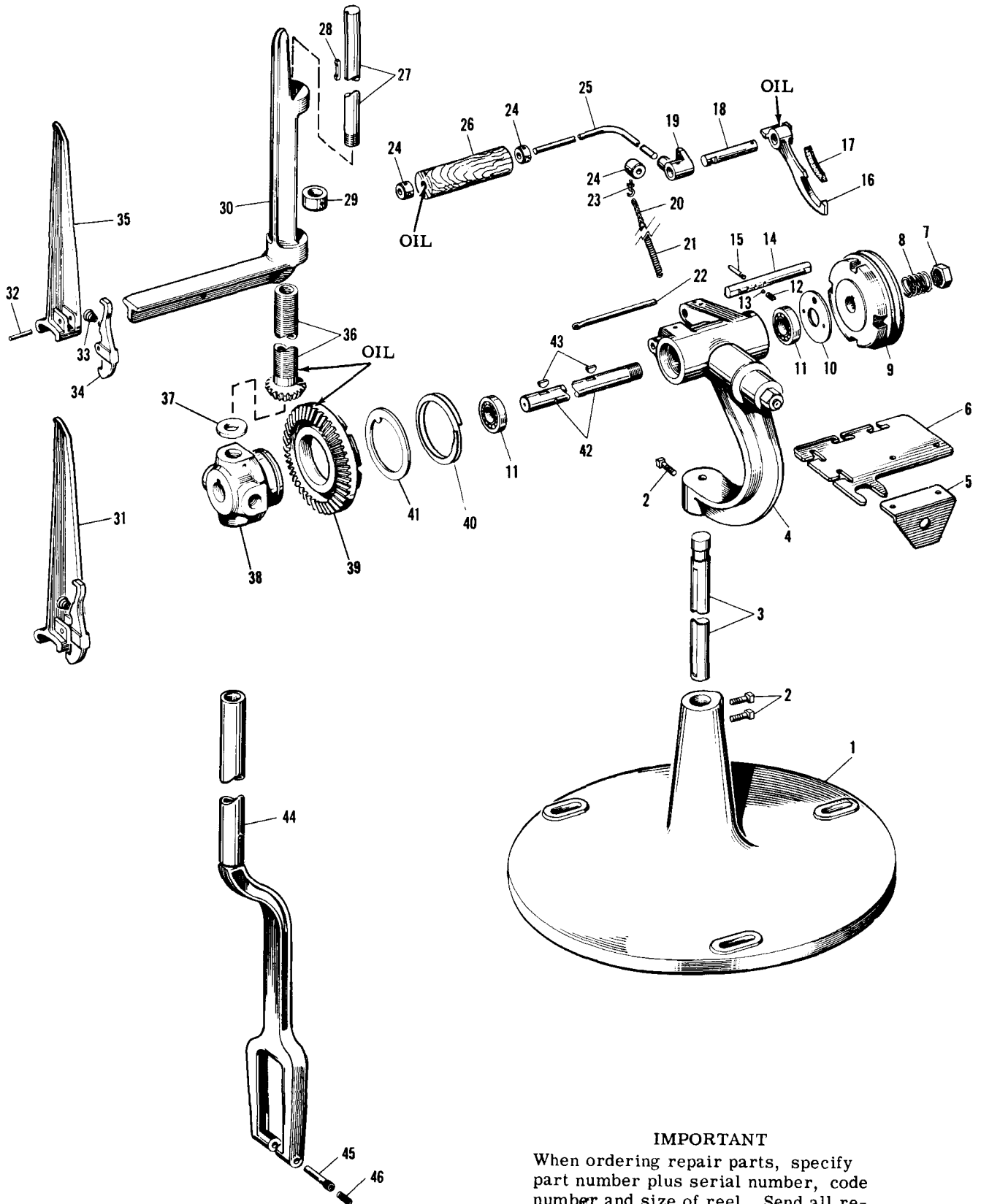

IMPORTANT

When ordering repair parts, specify part number plus serial number, code number and size of reel. Send all repair parts orders to the Chicago factory.

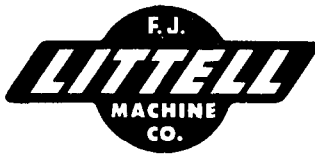

No. 3G AND No. 5G AUTOMATIC CENTERING REELS WITH AUTOMATIC BRAKE

OPERATING INSTRUCTIONS

A. REMOVE KEEPERS. Release keeper catch (34) and remove keepers (31) from arms. Place keepers in slots provided in keeper plate (6) while loading coil.

B. COLLAPSE ARMS.

(1) Slide shifter pin (15) forward so that lock pin (14) engages slot in bevel gear (39) to prevent gear from turning.

(2) Rotate spider in a clockwise direction until the arms (30) have contracted to at least 1 to 2 inches smaller than the inside diameter of the coil to be loaded.

C. LOCK SPIDER.

(1) Position spider so that one of the arms (30) is in a vertical position.

(2) Slide shifter pin (15) rearward so that lock pin (14) engages slot in locking disc (9) to prevent spider from rotating.

D. LOAD COIL.

(1) Insert loading lever (44), if used, through the coil and attach end of lever, with pivot pin (45), to holes provided in bottom portion of the uppermost vertical arm (30).

(2) Raise loading lever to bring coil up to proper position. Slide coil onto the arms.

E. ATTACH KEEPERS. Snap keepers (31) into position on the arms so that the coil is tight against the back portion of the arms.

F. EXPAND ARMS.

(1) Slide shifter pin (15) forward so that lock pin (14) engages slot in bevel gear (39) to prevent gear from turning.

(2) Rotate spider in a counterclockwise direction until the coil is held firmly by all four arms.

(3) Disengage lock pin (14) from bevel gear (39) by sliding shifter pin (15) rearward to its central position in swivel body (4).

G. ADJUST SPIDER TENSION. Tighten or loosen adjusting spring nut (7) as necessary to obtain desired tension on the spider.

H. ADJUST BRAKE ARM. Unwind the coil, placing it under the wood roller (26). The amount of pull required to raise the brake control arm (25) can be obtained by moving the collar (24), up and down the arm. Be sure the spring (21) does not exert too much tension, as it will prevent arm from dropping down and applying brake when an excess of stock has been paid-off.

MAINTENANCE INSTRUCTIONS

All Littell Reels are of rigid construction and, if the capacities are not exceeded, will give years of trouble free service. The only maintenance necessary is the lubricating of points shown on the exploded view, and replacement of worn brake lining. Do not permit oil to come in contact with brake pulley or brake.

F. J. LITTELL MACHINE CO.

4101 NORTH RAVENSWOOD AVENUE

CHICAGO 13, ILLINOIS

Form No. 705-1



No. 3G AND No. 5G AUTOMATIC CENTERING REELS WITH AUTOMATIC BRAKE

OPERATING INSTRUCTIONS

A. REMOVE KEEPERS. Release keeper catch (34) and remove keepers (31) from arms. Place keepers in slots provided in keeper plate (6) while loading coil.

B. COLLAPSE ARMS.

(1) Slide shifter pin (15) forward so that lock pin (14) engages slot in bevel gear (39) to prevent gear from turning.

(2) Rotate spider in a clockwise direction until the arms (30) have contracted to at least 1 to 2 inches smaller than the inside diameter of the coil to be loaded.

C. LOCK SPIDER.

(1) Position spider so that one of the arms (30) is in a vertical position.

(2) Slide shifter pin (15) rearward so that lock pin (14) engages slot in locking disc (9) to prevent spider from rotating.

D. LOAD COIL.

(1) Insert loading lever (44), if used, through the coil and attach end of lever, with pivot pin (45), to holes provided in bottom portion of the uppermost vertical arm (30).

(2) Raise loading lever to bring coil up to proper position. Slide coil onto the arms.

E. ATTACH KEEPERS. Snap keepers (31) into position on the arms so that the coil is tight against the back portion of the arms.

F. EXPAND ARMS.

(1) Slide shifter pin (15) forward so that lock pin (14) engages slot in bevel gear (39) to prevent gear from turning.

(2) Rotate spider in a counterclockwise direction until the coil is held firmly by all four arms.

(3) Disengage lock pin (14) from bevel gear (39) by sliding shifter pin (15) rearward to its central position in swivel body (4).

G. ADJUST SPIDER TENSION. Tighten or loosen adjusting spring nut (7) as necessary to obtain desired tension on the spider.

H. ADJUST BRAKE ARM. Unwind the coil, placing it under the wood roller (26). The amount of pull required to raise the brake control arm (25) can be obtained by moving the collar (24), up and down the arm. Be sure the spring (21) does not exert too much tension, as it will prevent arm from dropping down and applying brake when an excess of stock has been paid-off.

MAINTENANCE INSTRUCTIONS

All Littell Reels are of rigid construction and, if the capacities are not exceeded, will give years of trouble free service. The only maintenance necessary is the lubricating of points shown on the exploded view, and replacement of worn brake lining. Do not permit oil to come in contact with brake pulley or brake.

F. J. LITTELL MACHINE CO.

4101 NORTH RAVENSWOOD AVENUE

CHICAGO 13, ILLINOIS

Form No. 705-1